

ROLACASE MERCEDES SPRINTER 170 WB HIGH ROOF ANCHOR KIT INSTALLATION MANUAL

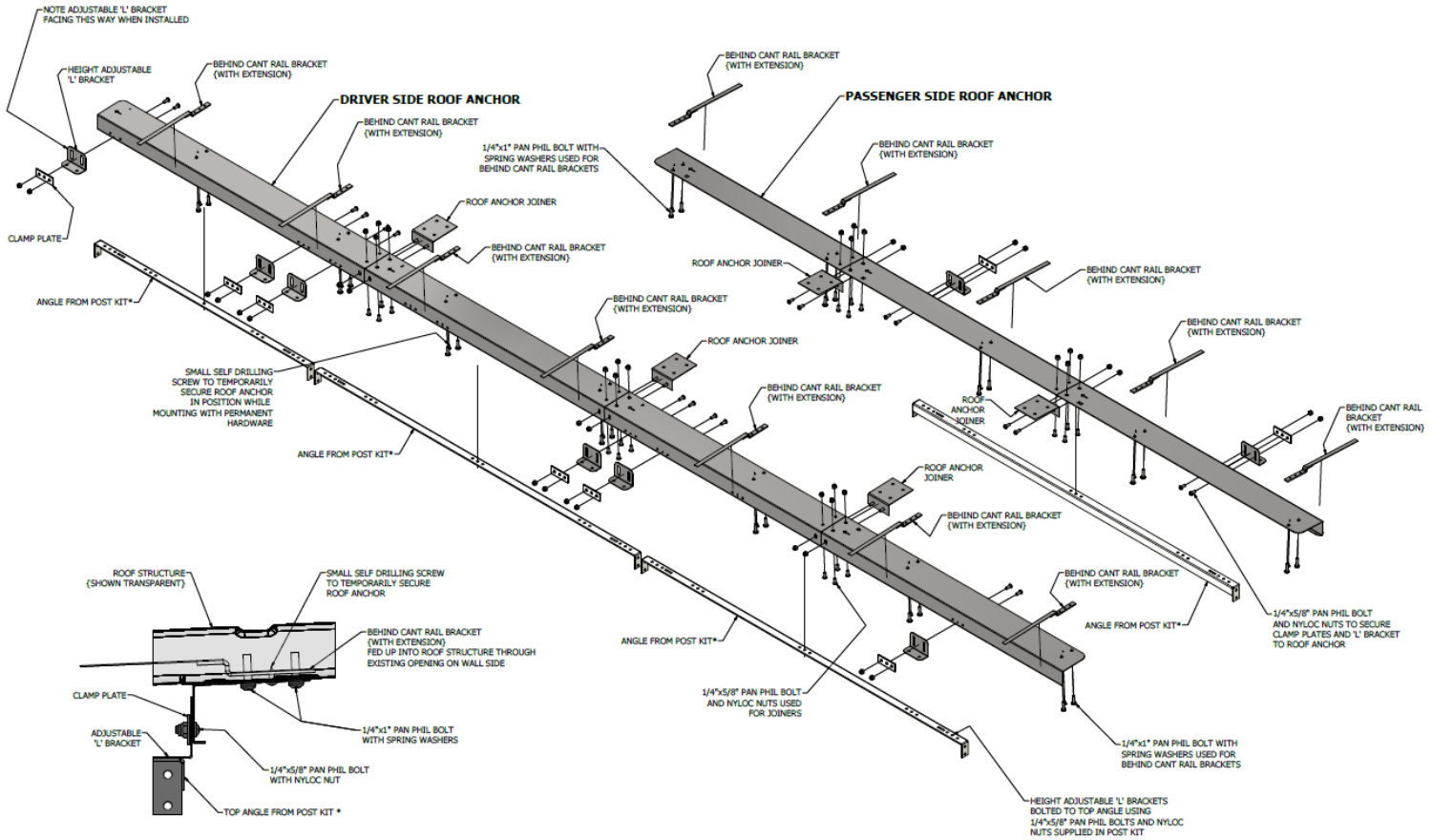

⚠ ATTENTION: PLEASE READ ALL INSTRUCTIONS BEFORE ASSEMBLING/INSTALLING THIS PRODUCT

Part#: RSVAKMS170HR21 suits the following models:

- 2019-2022 Mercedes Sprinter 1500 HIGH roof 170" W/B
- 2010-2022 Mercedes Sprinter 2500 HIGH roof 170" W/B
- 2010-2022 Mercedes Sprinter 3500 HIGH roof 170" W/B







BEFORE YOU BEGIN

- The average expected install time for this product is **80 minutes**
- Print a copy of these instructions in color then read all the information before assembly & installation
- Always wear appropriate Personal Protective Equipment, especially eyewear when installing our products
- Ensure you have some assistance from a second person to avoid vehicle damage or any personal injury
- Be aware of the location of vehicle wiring, gas tanks, gas lines, brake lines, & any other important items
- Ensure it is safe before drilling or cutting anywhere on the vehicle & installing any of our products
- Confirm you have all the necessary parts, tools, equipment, & time required before commencing

All design concepts are the intellectual property of RolaCase & are not to be copied, distributed or communicated to unauthorised parties

For Technical Support call: 1(857) 334 0300 Email: support@usrolacase.com Website: www.rolacase.com

TOOLS REQUIRED

Cordless Drill with Torque & Impact Hammer settings	Drill Bits	Measuring tape and a marker pen	Screw Drivers	Ratchet, sockets, and or spanners	Rivet Nut tool
					

⚠ WARNING

ANY ALTERATIONS, UNINTENDED OR UNAPPROVED WORK/USE OF THIS PRODUCT COULD CREATE A HAZARDOUS CONDITION THAT CAN CAUSE DEATH, PERSONAL INJURY OR PROPERTY DAMAGE.

⚠ ATTENTION

IMAGES USED IN THIS GUIDE MAY VARY SLIGHTLY DEPENDING ON YOUR MODEL

⚠ ATTENTION

The RolaCase Roof Anchor Kit for the Mercedes Sprinter (Part#: **RSVAKMS170HR21**) is made up of the following 12 parts that need to be located and assembled with the hardware provided:

ROOF ANCHORS

- 1) Drivers side (LH) rear roof anchor
- 2) Drivers side (LH) rear middle roof anchor
- 3) Drivers side (LH) front middle roof anchor
- 4) Drivers side (LH) front roof anchor
- 5) Passenger side (RH) front middle roof anchor
- 6) Passenger side (RH) rear middle roof anchor
- 7) Passenger side (RH) rear roof anchor
- 8) Anchor Joiners
- 9) Behind cant rail brackets (with extensions)
- 10) Height adjustable angle plates
- 11) Clamp plates
- 12) All necessary roof hardware (*refer to roof anchor section*)

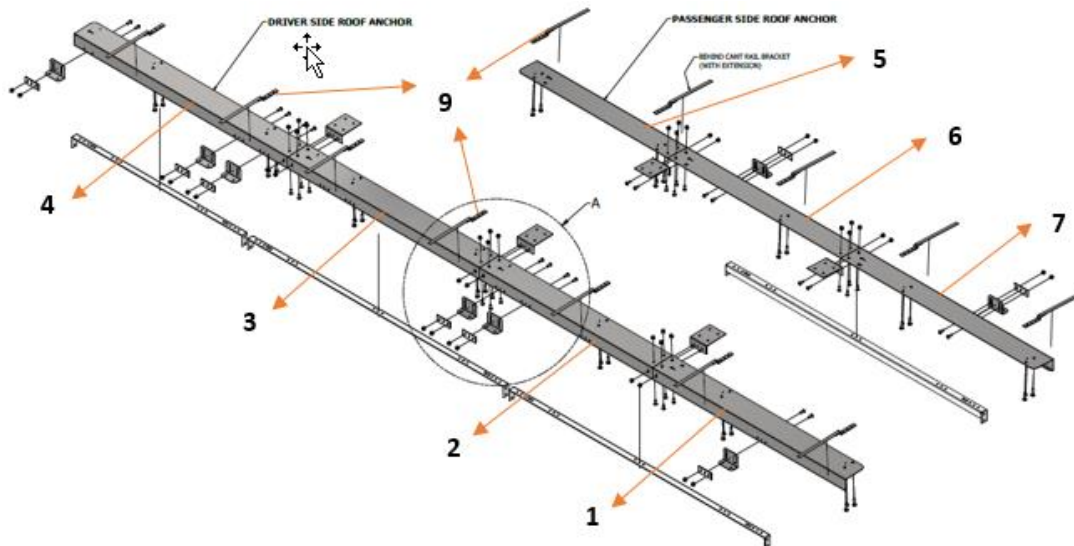
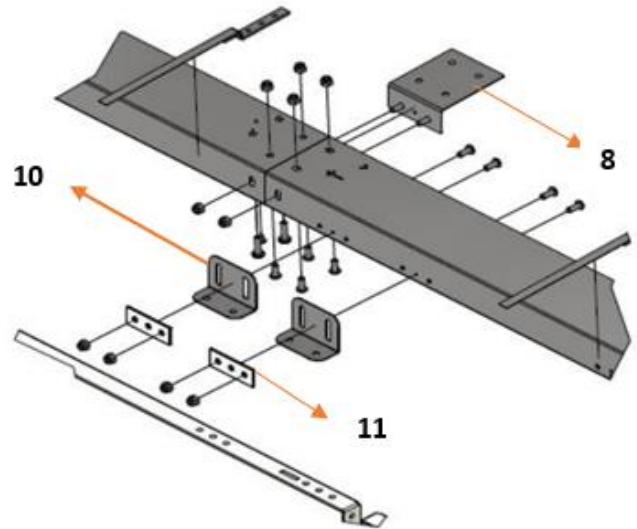

All design concepts are the intellectual property of RolaCase & are not to be copied, distributed or communicated to unauthorised parties

The RolaCase Floor Anchor Kit for the Mercedes Sprinter 170"WB (Part #: **RSVAKMS170SHR21**) is made up of the following 7 parts that need to be located and assembled together with the hardware provided:

FLOOR ANCHORS

- 1) Drivers side (LH) rear floor anchor
- 2) Drivers side (LH) middle rear floor anchor
- 3) Drivers side (LH) middle front floor anchor
- 4) Drivers side (LH) front floor anchor
- 5) Passenger side (RH) rear floor anchor
- 6) Passenger side (RH) middle floor anchor
- 7) All necessary floor hardware (*refer to floor section*)

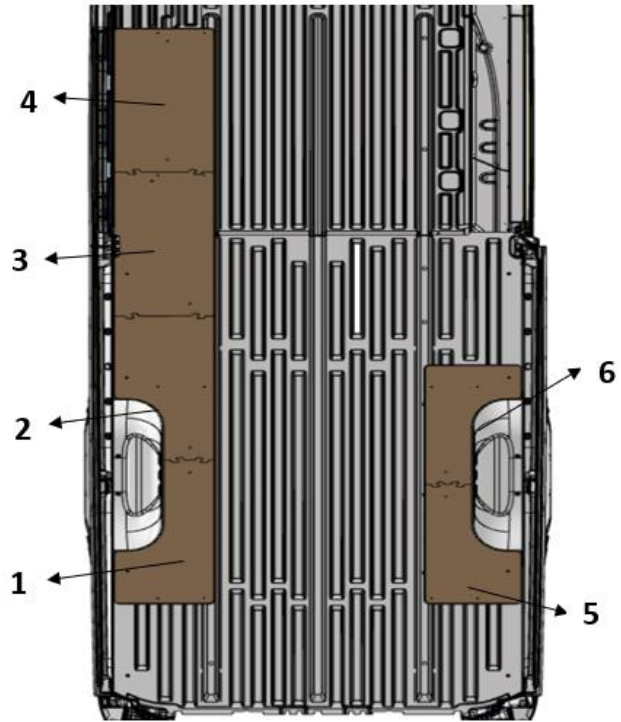

HARDWARE INCLUDED WITH THIS KIT FOR THE ROOF ANCHOR BRACKETS

HARDWARE	QUANTITY
PAN PHIL BOLT 1/4"x5/8"	46
PAN PHIL BOLT 1/4"x1"	24
SELF DRILLING SCREWS #8x12mm	12
NYLOC NUT 1/4"	46
SPRING WASHER 1/4"	24
CLAMP PLATE	8
HEIGHT ADJUSTABLE ANGLE	8
ANCHOR JOINER	5
BEHIND CANT RAIL with EXTENSION	12

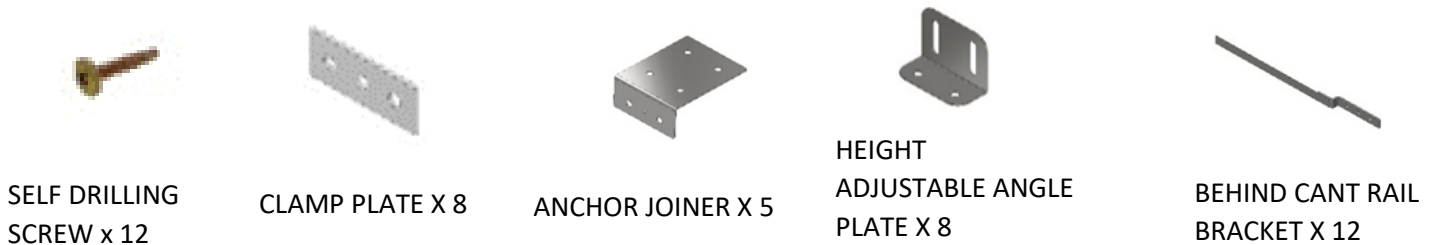
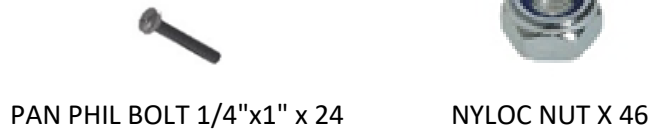
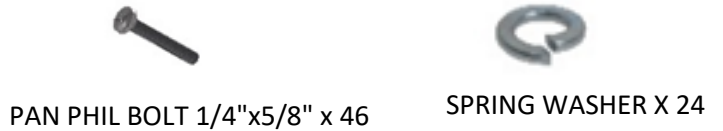

All design concepts are the intellectual property of RolaCase & are not to be copied, distributed or communicated to unauthorised parties

For Technical Support call: 1(857) 334 0300 Email: support@usrolacase.com Website: www.rolacase.com

SECTION - 1

ROOF ANCHOR BRACKETS

- a) Begin by confirming the wheelbase of your Mercedes Sprinter. Note that these roof anchors will suit the 170" WB model only
- b) Locate the box that contains the set of RolaCase Mercedes Sprinter Roof Anchors and open it, there should be SEVEN metal sections, FOUR for the Left, THREE for the Right, & a bag of supporting brackets, nuts, bolts, & washers for each side.
- c) Locate the passenger side or RH front, RH middle, and the RH rear roof anchor. This guide is for a 170" WB model which means will need to assemble the three pieces together with a Joiner and 6 x (1/4" x 5/8") bolts and nyloc nuts supplied per joiner bracket. Refer to images below:

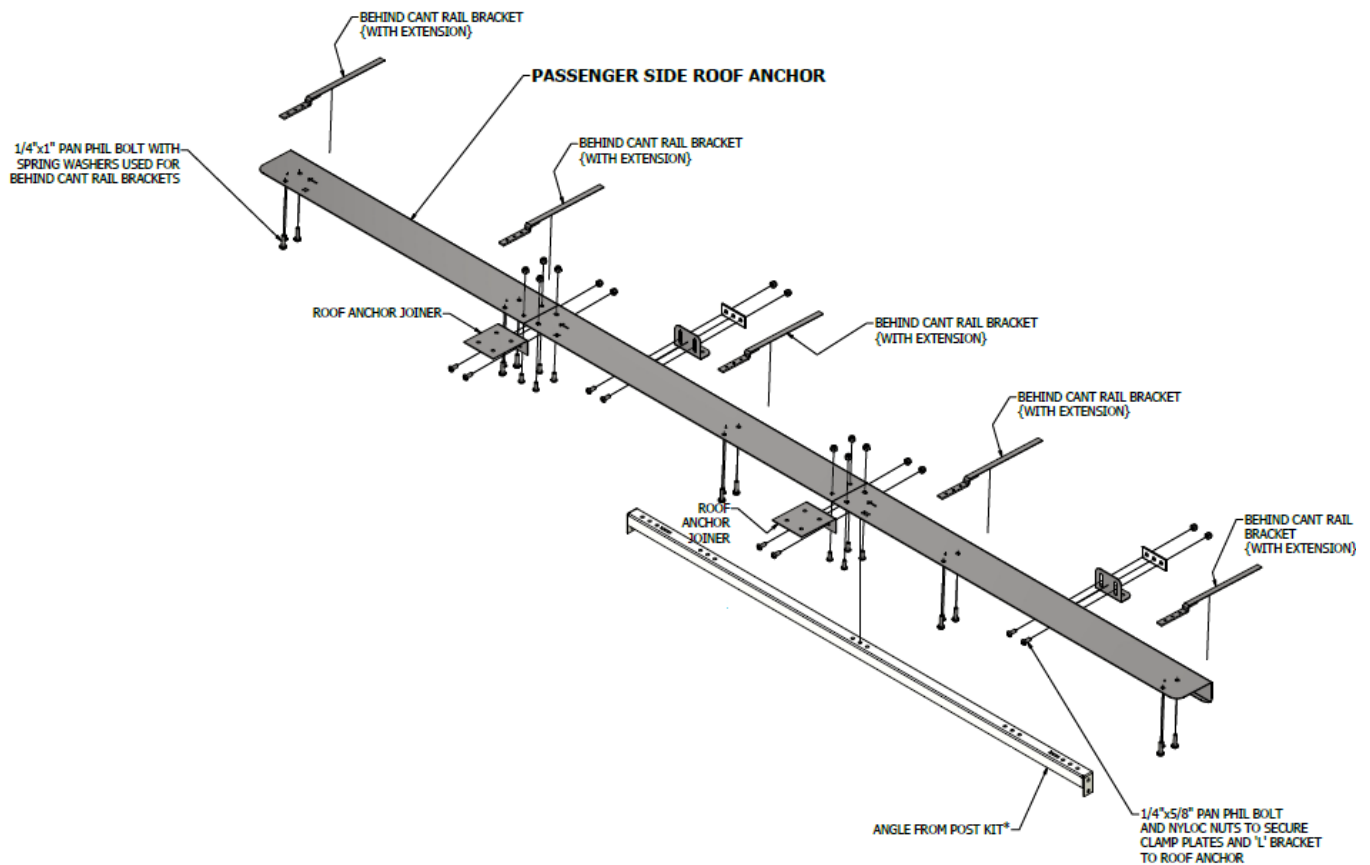

FOR A BIGGER IMAGES PLEASE VIEW THE LAST PAGE OF THIS GUIDE

- d) Locate the drivers side or LH front middle, LH rear middle, and the LH rear roof anchor, assemble the three pieces together with a Joiner and 6 x (1/4" x 5/8") bolts and nyloc nuts supplied per joiner bracket. Proper assembly for the LH should result in a mirror image of what was completed for the RH side

All design concepts are the intellectual property of RolaCase & are not to be copied, distributed or communicated to unauthorised parties

For Technical Support call: 1(857) 334 0300 Email: support@usrolacase.com Website: www.rolacase.com

e) Now locate the drivers' side or LH front roof anchor and the assembled three-piece LH roof anchor assembly from the previous step and assemble the two pieces with a Joiner and 6 x (1/4" x 5/8") bolts and nyloc nuts supplied. Proper assembly for the entire four-piece LH anchor in 170" spec should appear as per the image below:

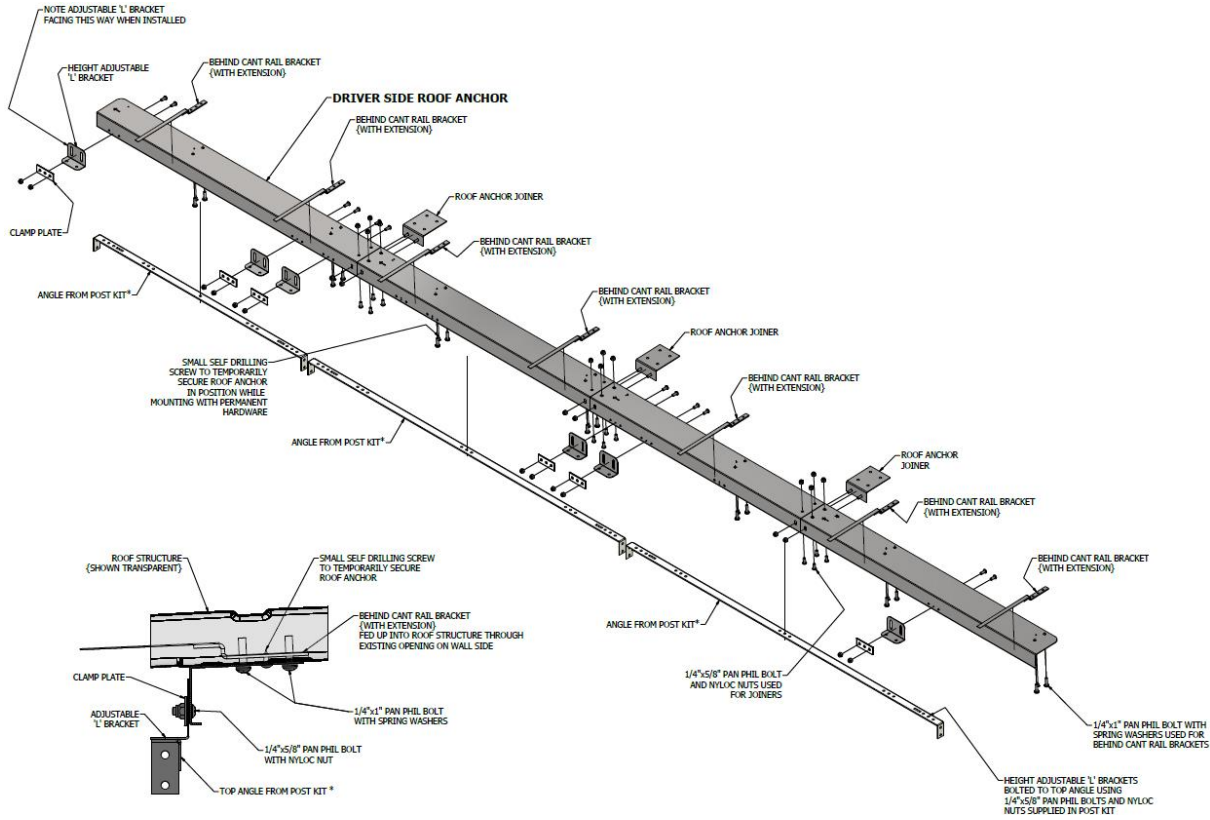

f) At this stage, you should have both the LH & RH roof anchors assembled in 170" spec configuration. Begin with the anchor or the RH side, use two people to lift the assembled Right-Hand upper roof anchor into position by lining up with the pre-punched holes in the bracket with a specific hole in the roof beams. Now carefully and temporarily secure the roof anchor to the side of the roof ribs through the small pilot holes with small gold self-tapping screws supplied and a cordless drill. Refer to the images below for correct alignment to specific hole

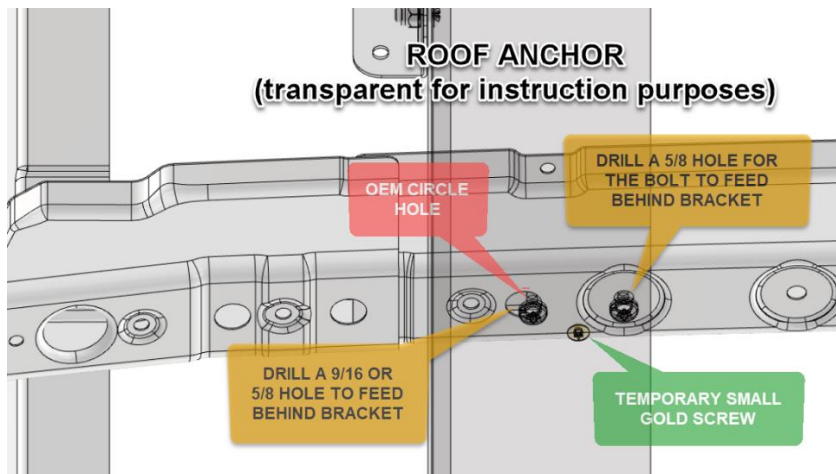

All design concepts are the intellectual property of RolaCase & are not to be copied, distributed or communicated to unauthorised parties

RIGHT-HAND ROOF ANCHOR IN 170" SPEC BELOW

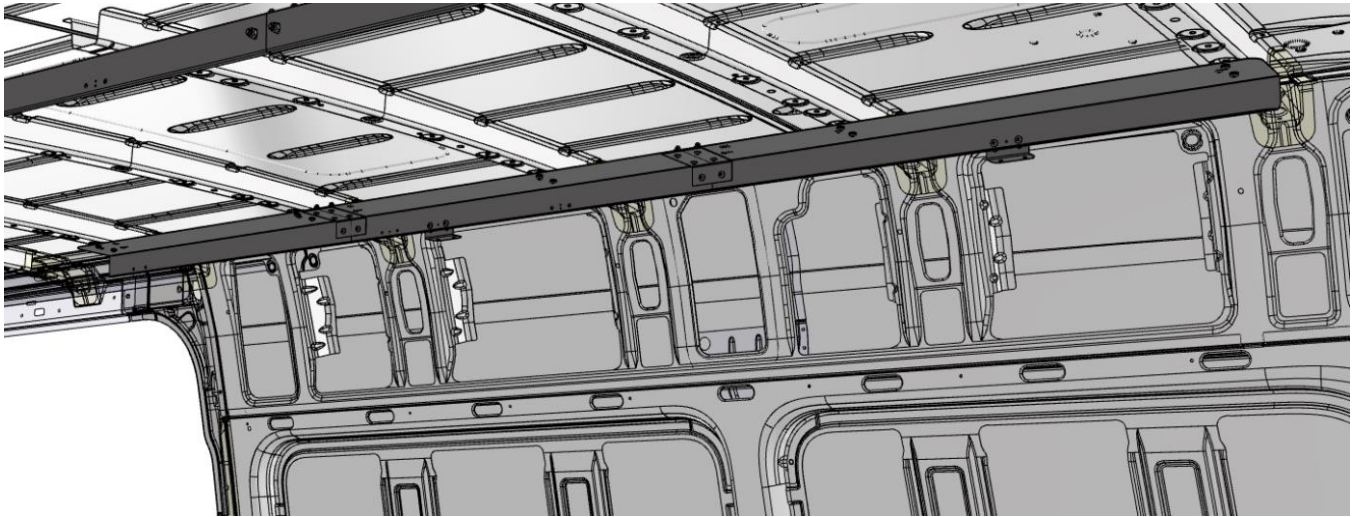

- g) Repeat the same process for the longer LH roof anchor

LEFT-HAND ROOF ANCHOR IN 170" SPEC BELOW

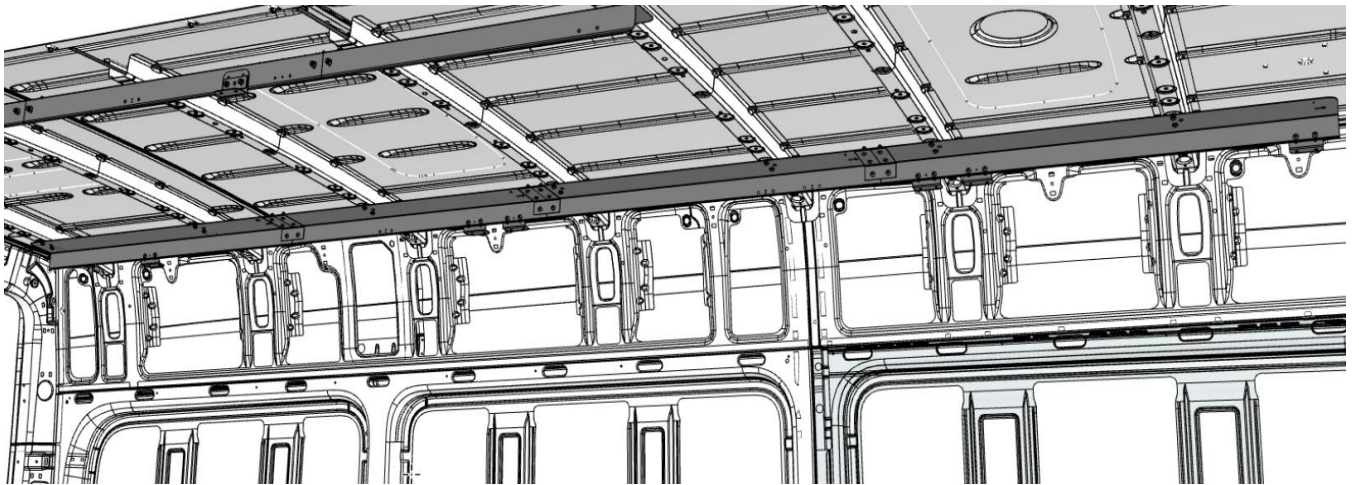

- h) Now it is time to properly secure the roof anchors to factory roof ribs. Locate the slim metal brackets with a long strip of metal spot welded to them (behind cant rail brackets) that have been provided with the anchors. Note that in some instances only one of the TWO circle holes in the anchor will line up with one OEM Circle hole in the beam. You will need to carefully drill a 9/16 hole in the beam where the square cut out is on the anchor so you can feed the bracket in, and drill a second 5/16 hole for one of the bolts. Insert these into the roof rail

All design concepts are the intellectual property of RolaCase & are not to be copied, distributed or communicated to unauthorised parties

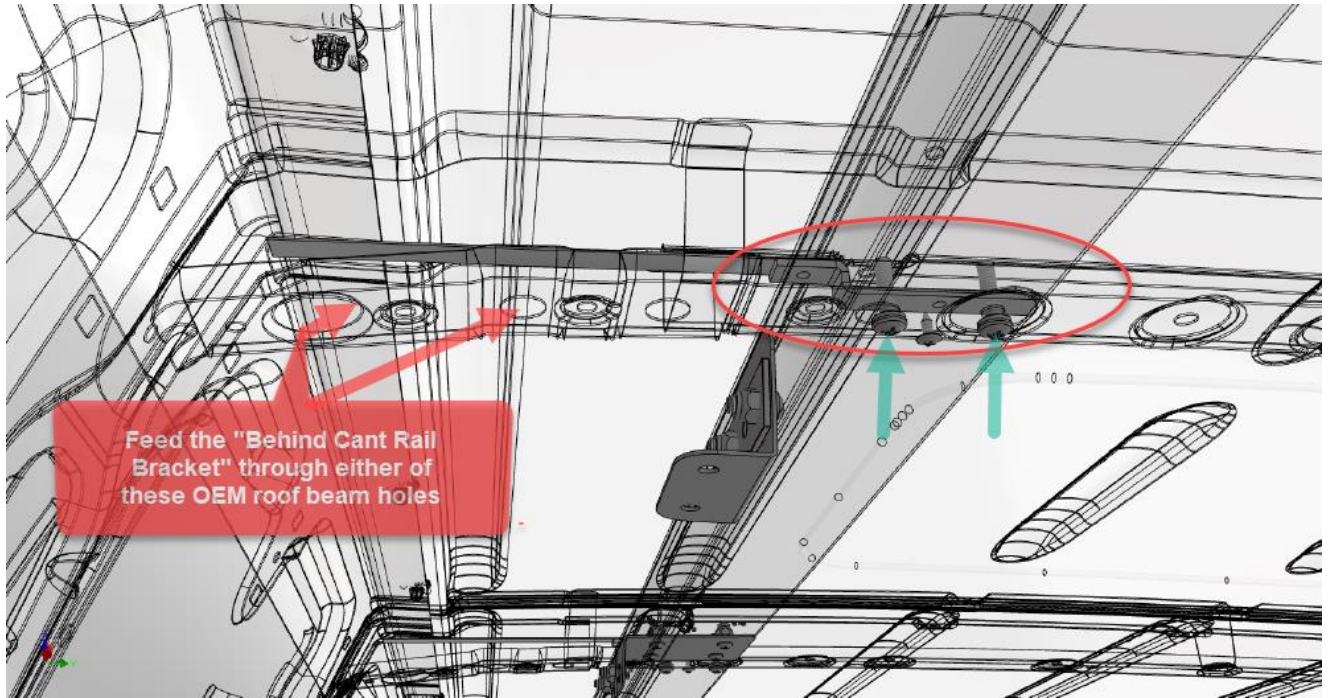

i) positions as per the image below:

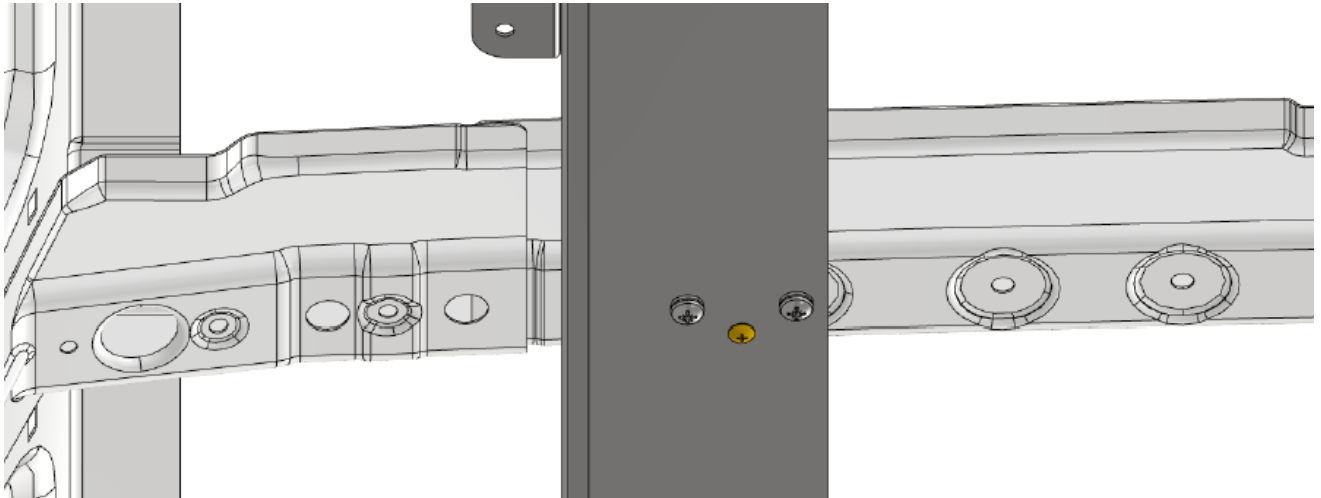

- j) Insert & feed the $\frac{1}{4}$ " x 1" bolts and spring washers through the anchor, through the OEM roof rail, and the thread on the brackets and tighten, this will secure or "sandwich" the anchor bracket to the roof beams resulting in a very strong anchor. Note, in some instances, you may need to carefully re-drill or elongate the OEM roof beam holes to match the ones on the roof anchor
- k) Repeat this process for both Right-Hand and Left-Hand roof anchors wherever there is contact with a roof beam structure.

All design concepts are the intellectual property of RolaCase & are not to be copied, distributed or communicated to unauthorised parties

Proper assembly and positioning on a 170" WB should appear as per the images below:

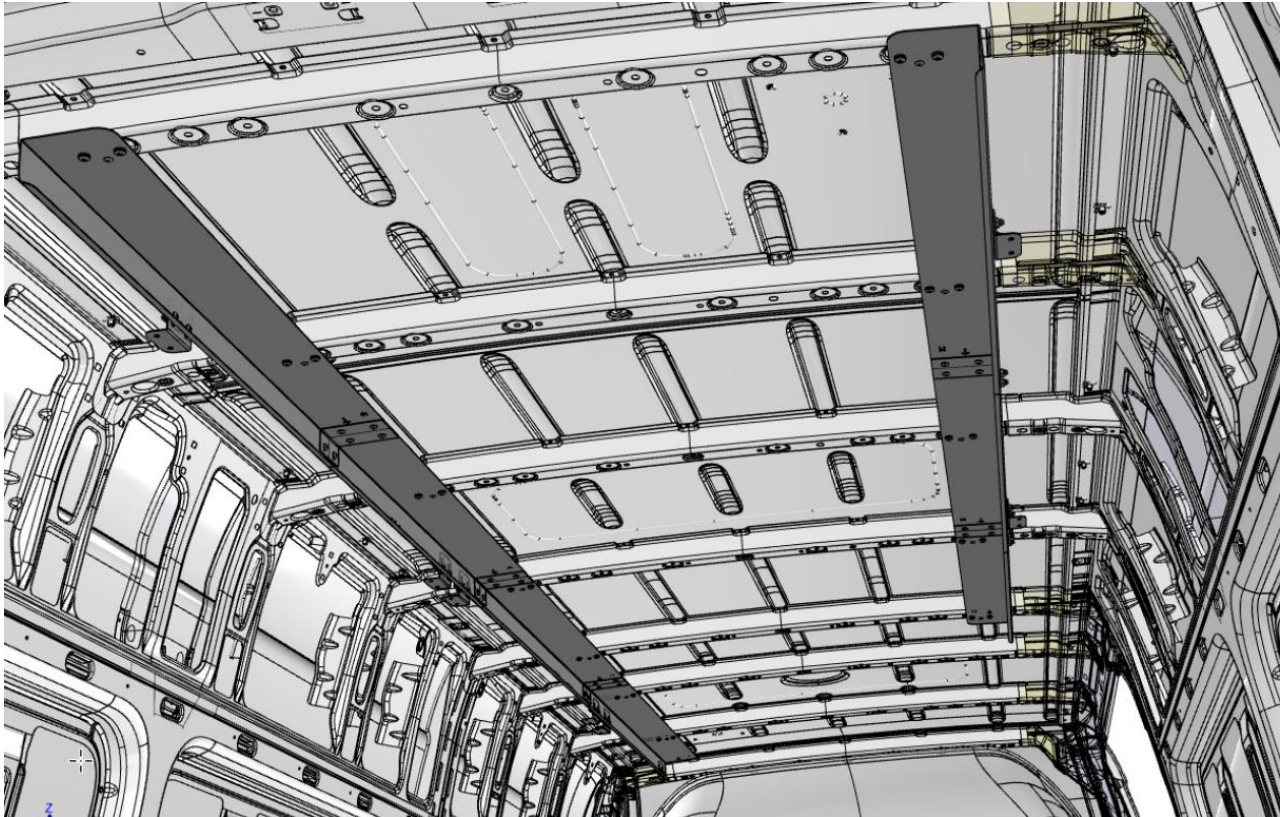

- l) Now that both the LH and RH roof anchors have been properly secured to the vehicle, it is now time to affix the height adjuster clamps to the anchors. With reference to the image below, assemble the clamps in the following configuration:

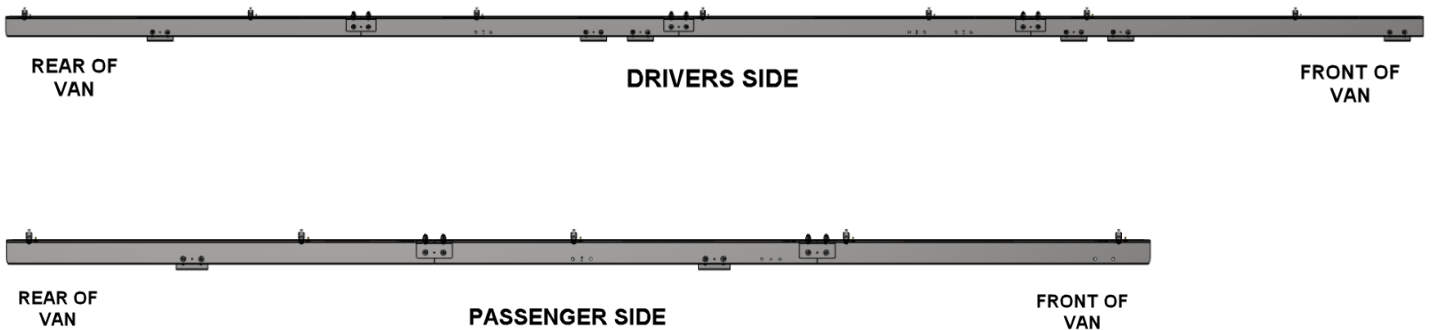

All design concepts are the intellectual property of RolaCase & are not to be copied, distributed or communicated to unauthorised parties

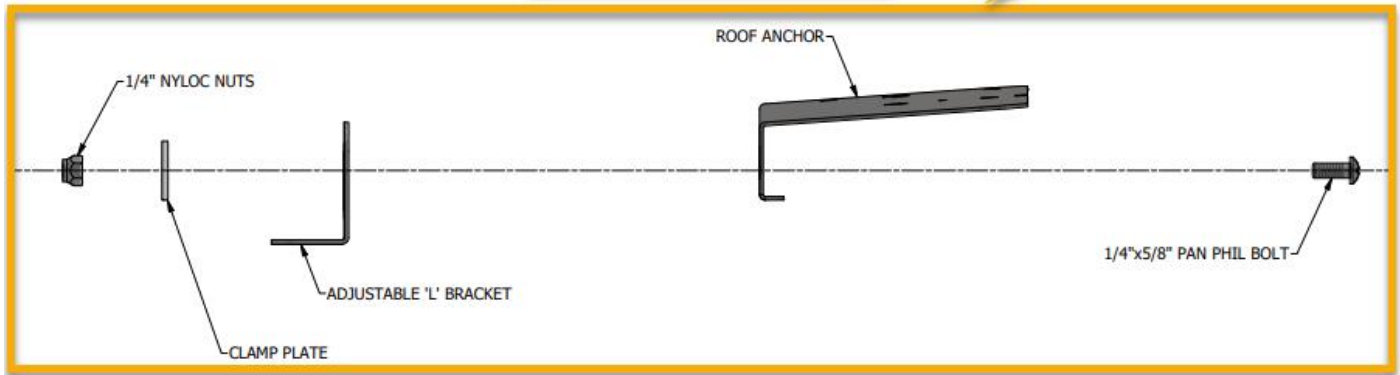
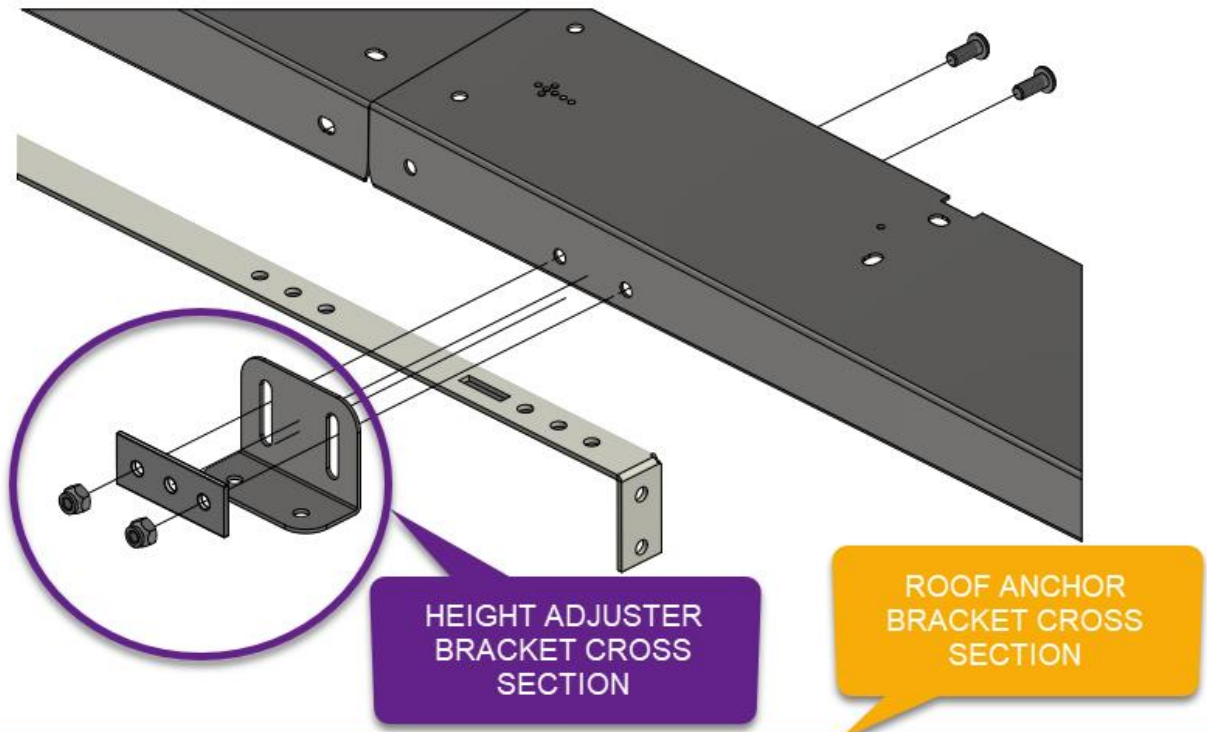

All design concepts are the intellectual property of RolaCase & are not to be copied, distributed or communicated to unauthorised parties

For Technical Support call: 1(857) 334 0300 Email: support@usrolacase.com Website: www.rolacase.com

SECTION - 2

FLOOR ANCHOR BRACKETS

HARDWARE	QUANTITY
HEX HEAD BOLT M8x40	12
WASHER M8	12
RIVET NUTS M8	12



HEX HEAD
BOLT X 12



WASHER X 12



RIVET NUT X 12

DRIVERS SIDE L/H FLOOR

- a) Begin by confirming the wheelbase of your Mercedes Sprinter. Note that these floor anchors will suit the 170" WB model only
- b) Locate the box that contains the set of RolaCase Mercedes Sprinter Floor Anchors plates, open it and identify the four L/H wooden floor plates. Position the four plates into their correct positions and secure them together by connecting the "jigsaw" pattern to make one larger plate. Refer to the image below:



- c) Place the assembled Left-Hand lower floor anchor into the correct position by ensuring it fits tight up against the wheel arch cut-outs and the wall of the van
- d) There are TWO pilot holes per wooden piece have been pre-drilled in this L/H floor anchor assembly. With the floor plate in the correct position, mark out the points on the OEM floor by using a marker pen through the holes on the wooden floor. You should be marking out 8 positions to drill in the next steps. Note that some of the holes have a metal "T-Nut" in them, these are not the holes you will be using to secure to the floor.
- e) Move the wooden floor section out of the way and drill through the OEM floor where you marked in the previous step and secure the 8 rivet nuts supplied into position. A drill bit to match the rivet nuts must be used.
- f) Re-position the wooden floor anchor and secure to the floor via 8 bolts and washers provided (2 per piece)

All design concepts are the intellectual property of RolaCase & are not to be copied, distributed or communicated to unauthorised parties

PASSENGER SIDE R/H FLOOR

- g) Locate the remaining two R/H wooden floor plates. Position them into their correct positions and secure them together by connecting the “jigsaw” pattern to make one larger plate. Refer to the image below:

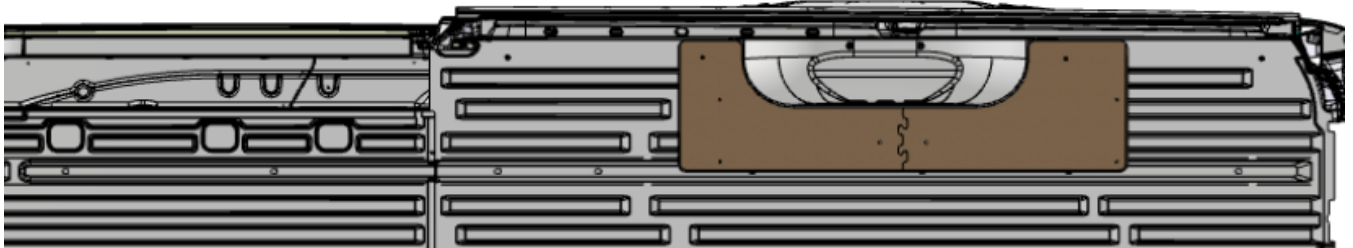

- h) Place the assembled Right-Hand lower floor anchor into the correct position by ensuring it fits tight up against the wheel arch cut-outs and the wall of the van
- i) There are TWO pilot holes per wooden piece have been pre-drilled in this R/H floor anchor assembly. With the floor plate in the correct position, mark out the points on the OEM floor by using a marker pen through the holes on the wooden floor. You should be marking out 6 positions to drill in the next steps. Note that some of the holes have a metal “T-Nut” in them, these are not the holes you will be using to secure to the floor.
- j) Move the wooden floor section out of the way and drill through the OEM floor where you marked in the previous step and secure the 4 rivet nuts supplied into position. A drill bit to match the rivet nuts must be used
- k) Re-position the wooden floor anchor and secure to the floor via 4 bolts and washers provided (2 per piec

Proper assembly and positioning should appear like the image below:

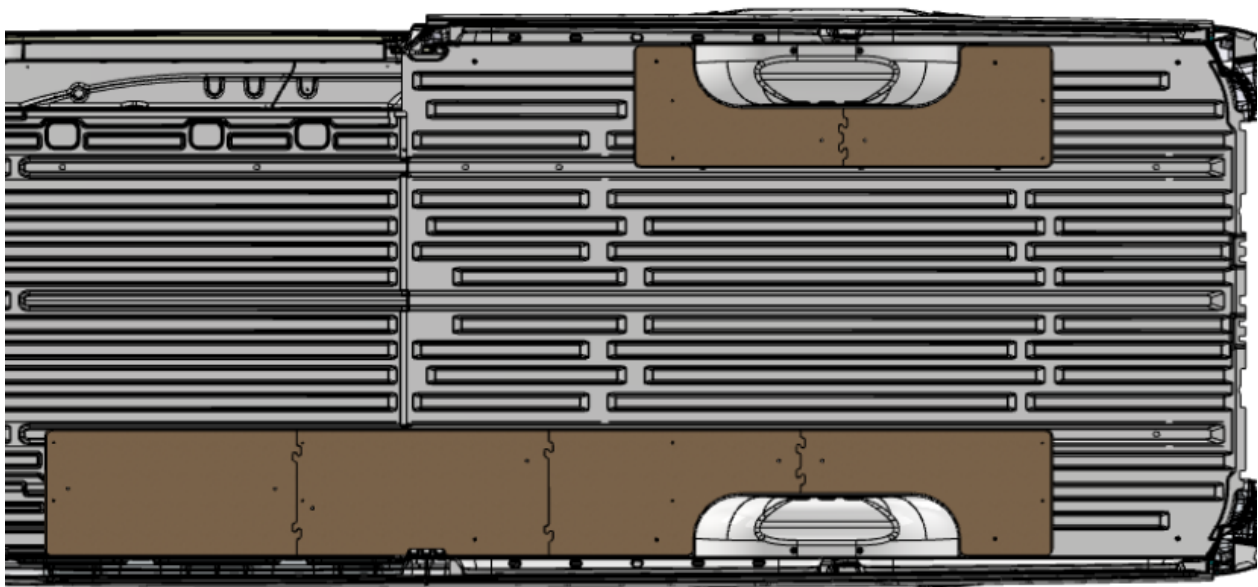

INSTALLATION COMPLETE

All design concepts are the intellectual property of RolaCase & are not to be copied, distributed or communicated to unauthorised parties

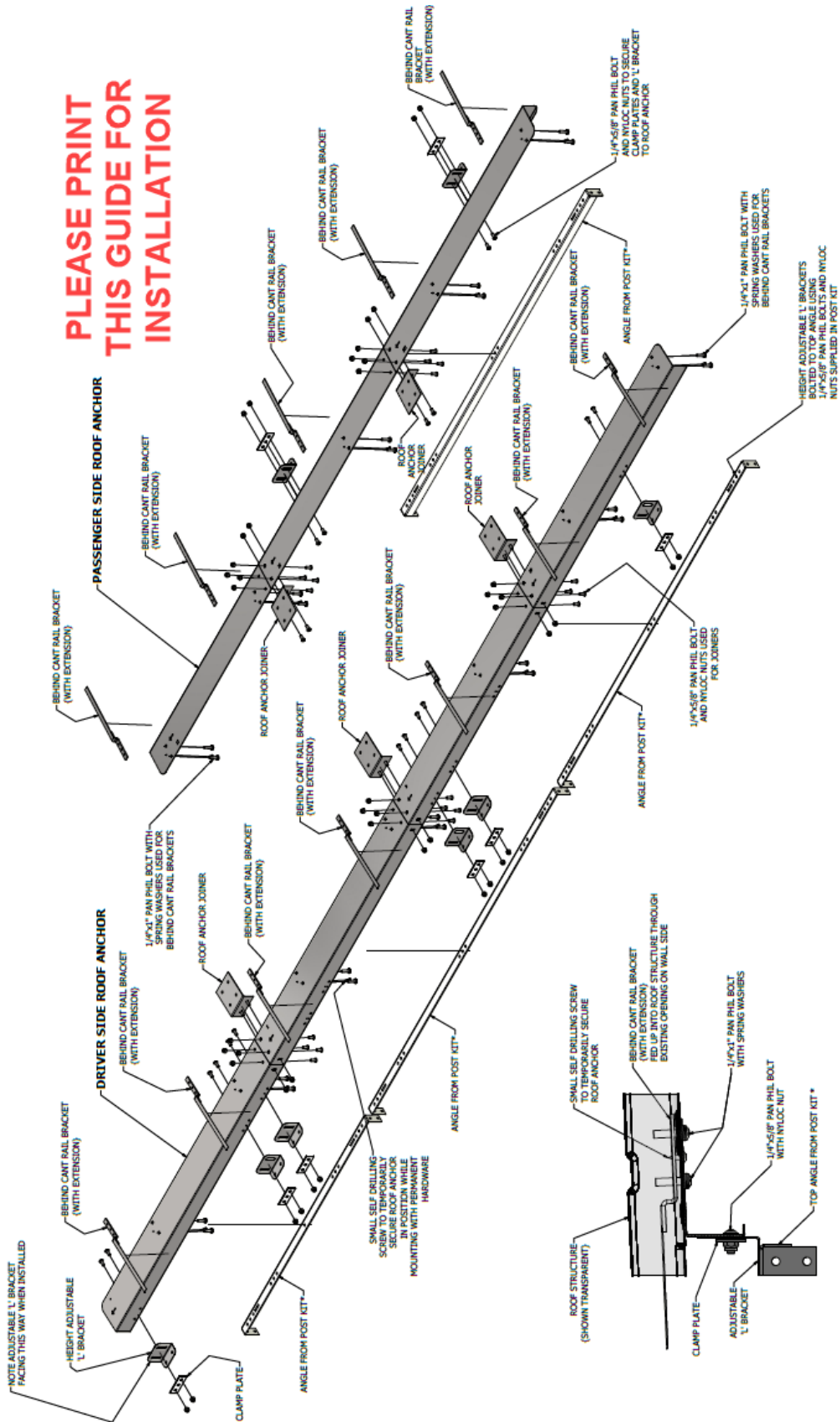

All design concepts are the intellectual property of RolaCase & are not to be copied, distributed or communicated to unauthorised parties

For Technical Support call: 1(857) 334 0300 Email: support@usrolacase.com Website: www.rolacase.com